



Fine atomization High Transfer Efficiency Super Compact Spray Gun



Because it's a DEMI "Pattern settings for a wide range of applications"

Fine atomization is achieved with pattern sizes for a wide range of applications, not only spot repairs but everything from ultra-small spot repairs to light repairs and panel coating.

Minimum pattern setting

Air pressure	0.05 MPa
Delivery (Fluid adjusting knob)	Open 1 turn from closed position
Pattern range (Pattern knob)	Closed position
Distance from cap	80 mm

- With an ultra-small pattern setting, excellent atomization performance is achieved by reducing air pressure and flow rate.

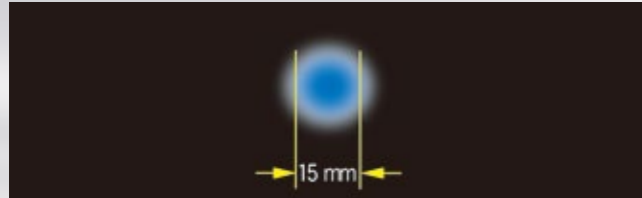

Maximum pattern setting

Air pressure	0.15 MPa
Delivery (Fluid adjusting knob)	Open 3.5 turns from closed position
Pattern range (Pattern knob)	Open position
Distance from cap	150 mm

- With the maximum pattern setting, the pattern width is 150 mm. Fine atomization for light repairs and panel coating despite this super compact size.

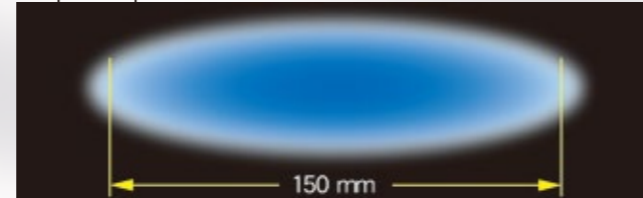

Because it's a DEVILBISS "Selection of film thickness and pattern size"

Specialized air caps despite the compact size. Different air caps can be selected, so the DEMI can be used for both flat coating and centre-heavy coating.

DM1
(Gold color)
For base coat

DM2
(Green color)
For clear coat

Flat
(Thin film / Even distribution)

- Coating thin film with even distribution.
- The most suitable for Metallics/Pearls.

Center heavy
(Thick film)

- Thick film with wide pattern width.
- The most suitable for Solids/Clears.



Comparing the existing air spray gun or HVLP gun, LVMP gun makes higher transfer efficiency and better atomization possible with less air consumption.

The structure of the DEMI

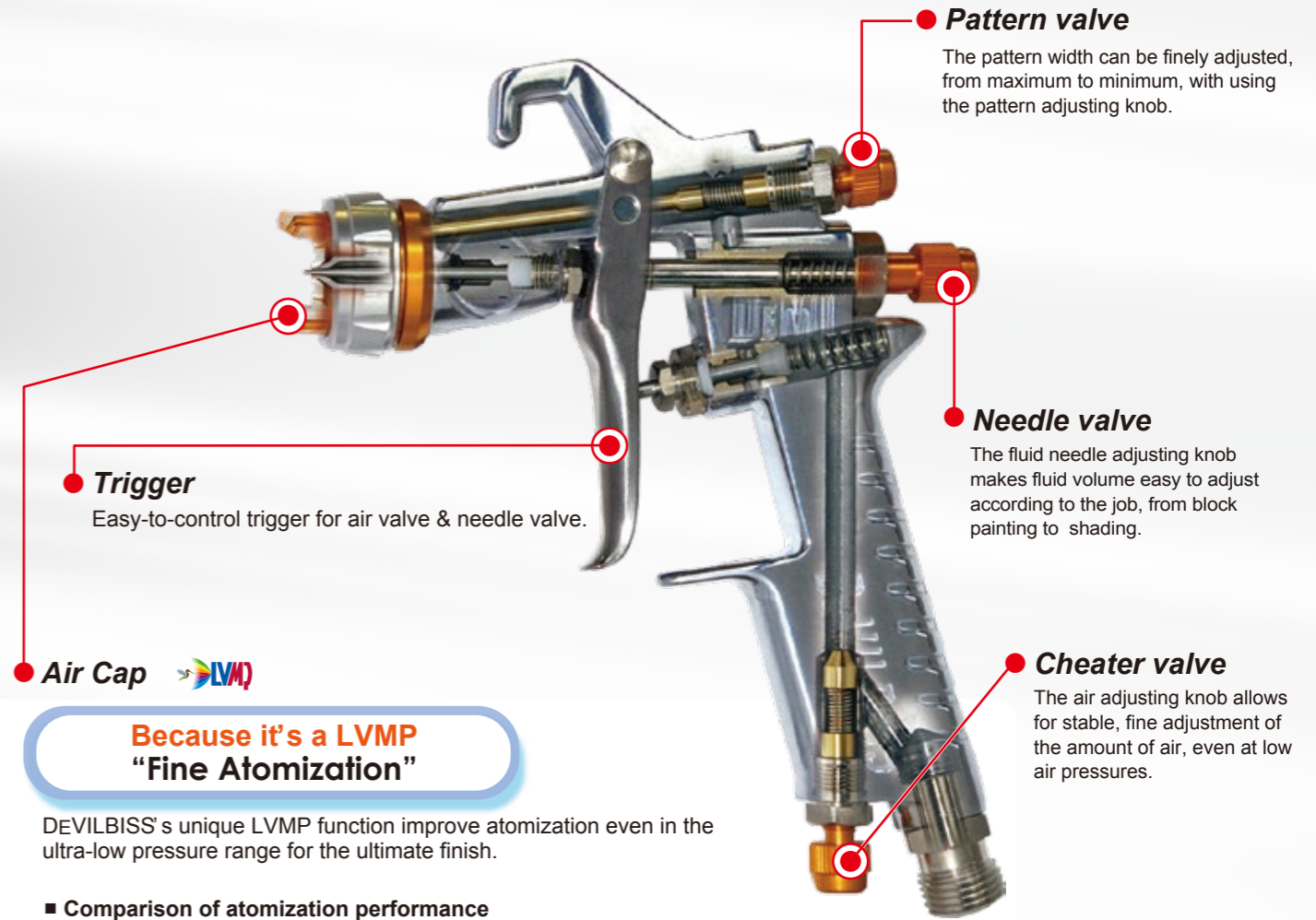

Because it's a LVMP "Fine Atomization"

DEVILBISS' s unique LVMP function improve atomization even in the ultra-low pressure range for the ultimate finish.

Comparison of atomization performance

	Pattern Setting Air inlet pressure / Delivery	Light repairs/panel coating	Ultra-small spots
		0.15 MPa / Open	0.05 MPa / 0.5 Turns
DEMI-DM1 Gun	LVMP	10.4 μm	4.4 μm
Conventional Gun	Standard air pressure	11.7~16.9 μm	4.7~7.0 μm

* Conditions of paint: (Viscosity:18 sec/NK-2), Distance from air cap (150 mm), Ambient temperature / humidity (25°C / 57%)

DEMI spray gun experience report

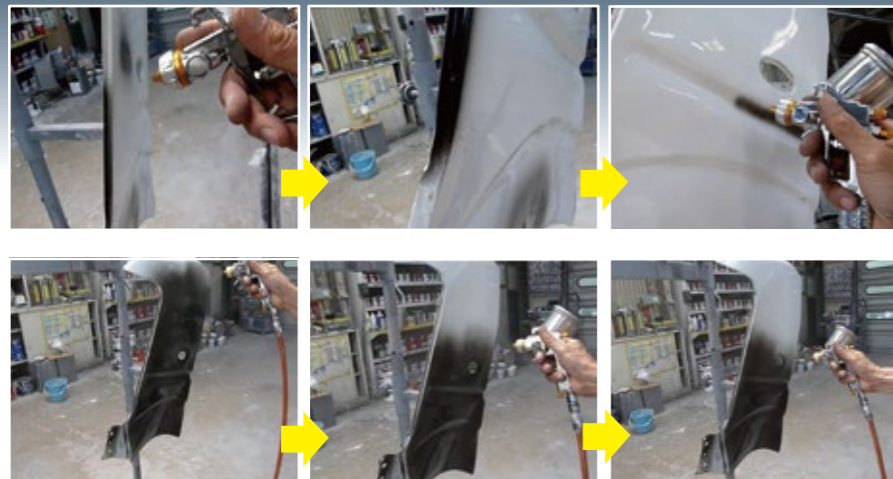

Impressions on using the DEMI spray gun

It is nice that the spray is extremely fine even with low pressure. With the DEMI, you can aim as you paint even in small places, so you don't need to paint wider areas. You don't need masking tape like you used to, and when shading off you only need to work with a small area.

The air cap performance of the GTi Pro LITE has been carried over. Atomization is good in the ultra-low pressure range, and there is little scattering. A special, distinctive air cap is used for the atomization pattern, making it even easier to apply coats.

What are the DEMI's applications?

The DEMI is suited for everything from repairing small scratches made after finishing to painting places that were difficult to paint with previous spray guns, such as inner coats. With this pattern width, even entire doors are easy to spray.

Despite the spray gun's small size, the maximum pattern width is 150 mm. The unique LVMP specifications make for high transfer efficiency, and there is no pattern splitting so the gun can be used for a wider range of applications.

DEMI spray gun usage examples

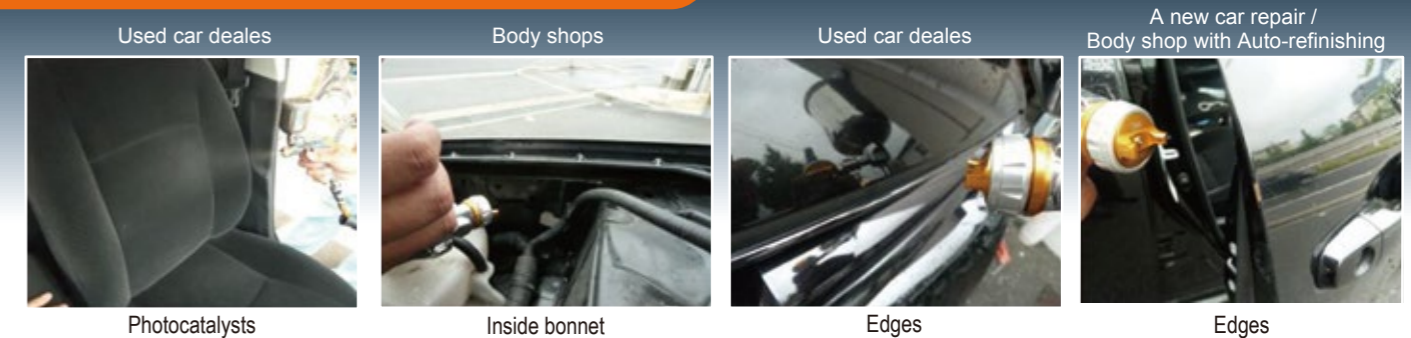

Comments from users

- The DEMI atomizes even at low pressures, so shading is easy and the DEMI is easier to use than other brands of spray guns.
- The DEMI is easy to use even for beginners, and gives a fine, equal finish even with slightly different air pressures.
- The handling and balance of gun are good.
- Atomization at low pressures is good, so the DEMI is suited for small objects to spray.
- I use it to repair dirt and dimples. There is little scattering and you can spray pinpoint, so it's very useful.
- I use it to repair on the edges of new car bonnets. Atomization is good even at low pressures, so it's easy to use. In the ultra-low pressure range, it is just as good as other brands, or even better.
- It is easy to use to repair small surfaces of bumpers. There is little scattering so you can keep the repair area small.
- I use the DM1, and there is not much unevenness with metallic surfaces so shading off is easy. With the DM2 it is easy to settle the colour base, so I choose my air cap accordingly.
- It is supposed to be good for small objects, but you can also use it for block painting.